

K-823-A

SWING CHECK VALVE

Flanged Ends



PRODUCT DESCRIPTION

General	Used to allow water flow in one direction and prevents the back flow in Fire Sprinkler Systems
Standard	Meets requirements of AWWA / ANSI C508
Size	2" to 12" [DN50 to DN300]
Pressure Rating	350 psi [24.1 Bar]
End Connection	Flange and Drilling comply with ASME B16.1 Class 125
Coating	Fusion Bonded Epoxy Coated comply with AWWA C550
Features	Internal parts are serviceable without need to remove the valve from the pipeline
Approvals	UL Listed and FM Approved

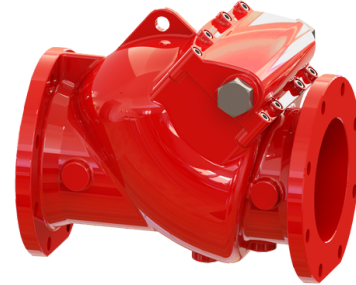

MATERIAL SPECIFICATIONS

No.	Part Name	Material
1	Body	Ductile Iron A536 Grade 65-45-12
2	Body Seat Ring	Bronze B62 C83600
3	Disc	Ductile Iron with EPDM Fully Encapsulated
4	Washer	Stainless Steel A276 Grade 304
5	Connecting Stem	Stainless Steel A276 Grade 316
6	Locking Nut	Stainless Steel A276 Grade 304
7	Bushing	Stainless Steel A276 Grade 304
8	Hinge (2" – 6")	Stainless Steel A351 Grade CF8
	Hinge (8" – 12")	Ductile Iron A536 Grade 65-45-12
9	Gasket	Rubber D2000 EPDM
10	Bonnet	Ductile Iron A536 Grade 65-45-12
11	Screw	Stainless Steel F593 Grade 304
12	Hinge Pin	Stainless Steel A276 Grade 304
13	Bushing	Bronze B62 C95200
14	O-Ring	Rubber D2000 EPDM
15	Locating Sleeve	Stainless Steel A276 Grade 304
16	Washer	Red Copper

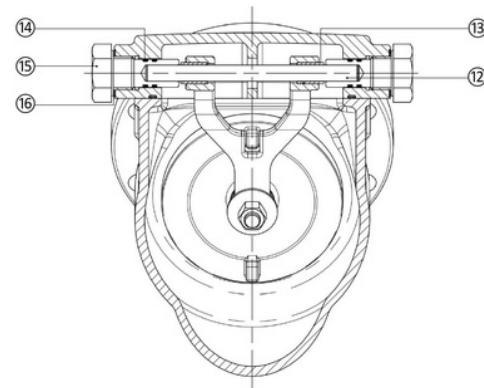
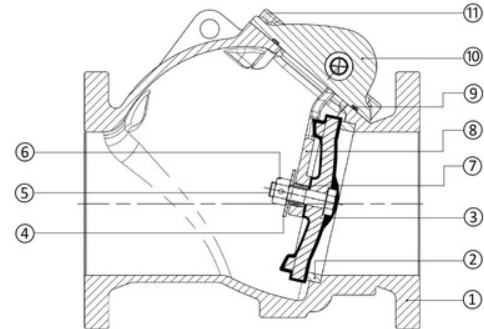

K-823-A**SWING CHECK VALVE**

Flanged Ends

**DIMENSIONS**

Valve Size		2"	2½"	3"	4"	6"	8"	10"	12"
L	in.	8.0	8.5	9.5	11.5	14.0	19.5	24.5	27.5
	mm	203	216	241	292	356	495	622	699
H	in.	4.1	4.4	4.9	6.2	8.1	10.4	12.0	14.0
	mm	104	112	124	157	207	264	304	355

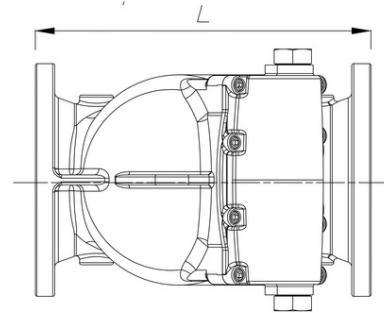
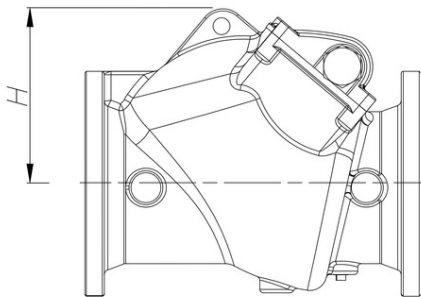
**WEIGHTS**

Valve Size		2"	2½"	3"	4"	6"	8"	10"	12"
Weight	lb.	23.15	28.66	36.38	55.12	103.62	195.11	330.69	485.02
	kg	10.50	13.00	16.50	25.00	47.00	88.50	150.00	220.00